



Double Take Totes

A SWEET SIXTEEN™ Project by WillowBerry Lane
Featuring Romance Flannel Sweet Sixteens™
& Full Sun Sweet Sixteens™



finished size 19" W X 13" H



Romance Flannel Fabric by WillowBerry Lane
Full Sun Fabric by Maywood Studio



& Maywood Studio

Maywood

Studio

A Division of E. E. Schenck Co.

6000 N. Cutter Cir.
4561 Maywood Ave

Portland, OR 97217
Vernon, CA 90058

800.433.0722
800.237.6620

503.284.4124
323.584.8820

Double Take Totes

A SWEET SIXTEEN™ Project by WillowBerry Lane
featuring Romance Flannel Sweet Sixteens™ and Full Sun Sweet Sixteens™

Fabric

Pick your favorite 16 patterns from the Romance Flannel or Full Sun Sweet Sixteen™ collection.
The quilt pictured on the front uses the following Sweet Sixteens™:

Full Sun

Sunflower & Butterfly (K)	Blue	MAS2118-B
Sunflower & Dot (P)	Blue	MAS2119-B
Sunflower & Dot (M)	Green	MAS2119-G
Geometric Design (L)	Blue	MAS2121-B
Geometric Design (A)	Yellow/Blue	MAS2121-EB
Geometric Design (B)	Yellow/Green	MAS2121-EG
Geometric Design (O)	Green	MAS2121-G
Stripe (E)	Yellow/Blue	MAS2122-EB
Stripe (F)	Yellow/Green	MAS2122-EG
Medallion Texture (J)	Blue	MAS2123-B
Medallion Texture (N)	Yellow	MAS2123-S1
Mono Sunflower (G)	Dark Blue	MAS2124-B1
Mono Sunflower (C)	Light Blue	MAS2124-B2
Mono Sunflower (D)	Green	MAS2124-G1
Mono Sunflower (H)	Light Green	MAS2124-G2
Plaid (I)	Yellow/Blue	MAS2125-B
Plus additional (Q)	1-1/4 yard	MAS2123-B



Romance Flannel

Scroll Texture (H)	Light Green	MASF2102-G2
Scroll Texture (C)	Light Red	MASF2102-R2
Leaves (J)	Light Green	MASF2104-G2
Leaves (N)	Light Red	MASF2104-PR
Scattered Allover (I)	Light Green	MASF2105-G2
Dot (F)	Gold	MASF2108-E
Dot (P)	Green	MASF2108-G
Dot (G)	Terracotta	MASF2108-R4
Rose Spray (K)	Nat/Blush	MASF2109-ER
Fern Texture (A)	Nat/Blush	MASF2111-WC
Fern Texture (B)	Nat/Green	MASF2111-WG
Mono Primrose (E)	Natural	MASF2117-E
Mono Primrose (O)	Red	MASF2117-R
Mono Primrose (D)	Green	MASF2117-G2
Shadow Play Flannel (L)		MASF513-G6
Shadow Play Flannel (M)		MASF513-R3
Plus additional (Q)	1-1/4 yard	MASF2104-G2



Fusible Fleece (R): 1 yard

(4) 3" Finished Half-Square BerriAngles (WBLHS3 at www.eeschenck.com)

Buttons (available at www.eeschenck.com) to match the fabric you choose:

(2) Teardrop buttons: DIB390117 Blue, DIB290119 Green or DIB390111 Beige

(2) Square buttons: DIB410050 Blue, DIB410052 Green or DIB410044 Beige

Cutting

Fabric	Label	1st Cut	2nd Cut
MAS2121-EB or MASF2111-WC	A	(1) 3-7/8" x 11"	(2) 3-7/8" x 3-7/8"
MAS2121-EG or MASF2111-WG	B	(1) 3-7/8" x 11"	(2) 3-7/8" x 3-7/8"
MAS2124-B2 or MASF2102-R2	C	(1) 3-7/8" x 11"	(2) 3-7/8" x 3-7/8"
MAS2124-G1 or MASF2117-G2	D	(1) 3-7/8" x 11"	(2) 3-7/8" x 3-7/8"
MAS2122-EB or MASF2117-E	E	(2) 3-1/2" x 11"	(4) 3-1/2" x 4-1/2"
MAS2122-EG or MASF2108-E	F	(2) 3-1/2" x 11"	(4) 3-1/2" x 4-1/2"
MAS2124-B1 or MASF2108-R4	G	(1) 4-1/2" x 4-1/2"	
MAS2124-G2 or MASF2102-G2	H	(1) 4-1/2" x 4-1/2"	
MAS2125-B or MASF2105-G2	I	(4) 2-1/8" x 10-1/2"	
MAS2123-B or MASF2104-G2	J-1	(2) 2-1/2" x 10-1/2"	
	J-2	(2) 1-1/2" x 10-1/2"	
MAS2118-B or MASF2109-ER	K	* (2) 4-1/2" x 10-1/2"	
MAS2121-B or MASF513-G6	L	(1) 8" x 10-1/2"	
MAS2119-G or MASF513-R3	M	(1) 8" x 10-1/2"	
MAS2123-S1 or MASF2104-PR	N	(2) 2-1/2" x 10-1/2"	
MAS2121-G or MASF2117-R	O	(2) 3" x 10-1/2"	
MAS2119-B or MASF2108-G	P	* (2) 4-1/2" x 10-1/2"	
MAS2123-B or MASF2104-G2	Q-1	(1) 8-1/2" x 44"	(2) 8-1/2" x 10-1/2"
	Q-2	(1) 13-3/4" x 44"	(2) 13-3/4" x 20-1/2"
	Q-3	(1) 5-1/2" x 44"	(2) 5-1/2" x 20"
	Q-4	(1) 1-1/4" x 9"	
Fusible Fleece	R-1	(4) 11" x 15"	
	R-2	(2) 9" x 11"	
	R-3	(2) 2-3/8" x 19-1/2"	

*Measurements don't need to be exact. If you are only able to cut scant 4-1/2" units from each 9" length sweet sixteen, the tote panels may be trimmed to the same size before joining.

All Seams are 1/4".
Press according to arrows, unless stated.

HST = Half-Square Triangle

RST = Right Sides Together

WSF = Wrong Side of Fabric

Piecing

Make this easy tote with your sweet sixteen packs. Have fun! We only have a few guidelines:

We use a notion we invented called BerriAngles for making the half-square triangles in this pattern. Give them a try and you'll find making triangles is easy and very accurate! See the diagram below for instructions.

HOW TO MAKE HALF-SQUARE TRIANGLES

BerriAngle Method

Traditional Method

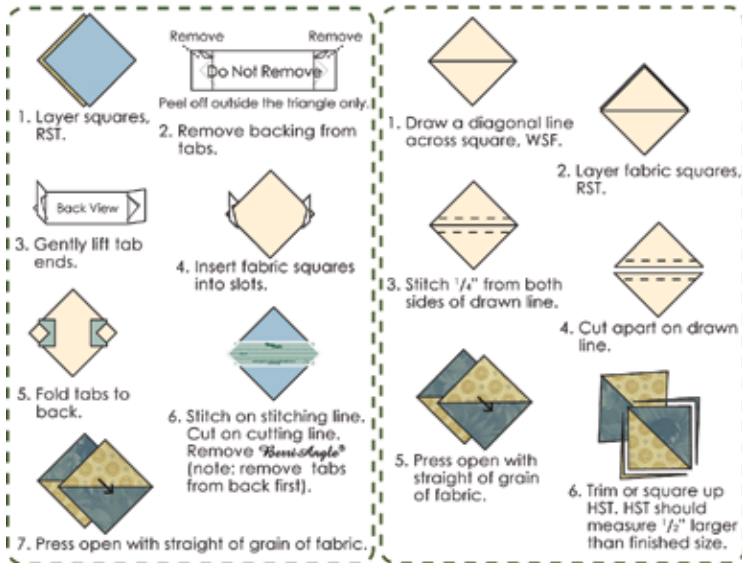

1. Layer A with C and B with D, RST. Make 3" Finished Half-Square triangles using one of the methods diagrammed above. Make 4 of each. HST measures 3-1/2" x 3-1/2".



2. Join as diagrammed. Press. Blocks A & B measure 10 1/2" x 10 1/2".

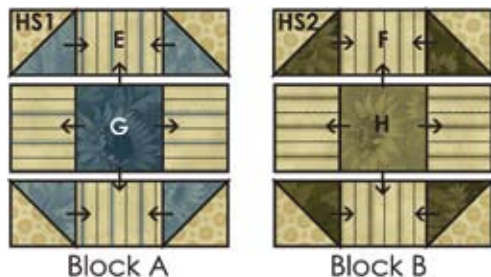

3. Join as diagrammed. Press.

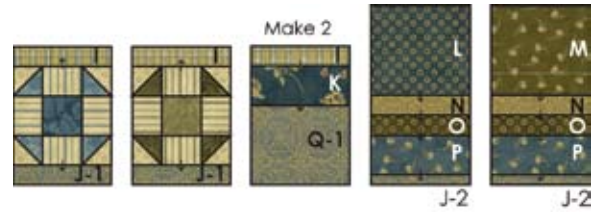

4. Layer panels on fusible fleece. (For Pocket panels fuse fleece to bottom half of panel). Press to fuse layers. Machine quilt as desired. Trim excess batting. (See diagram for quilting ideas.)

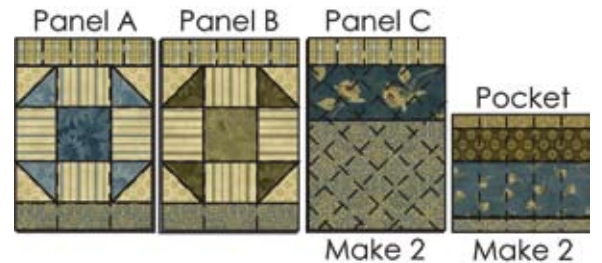

5. Baste pockets to Panel C.



6. Trim panels to same size, if necessary, and join panels as diagrammed. Press.

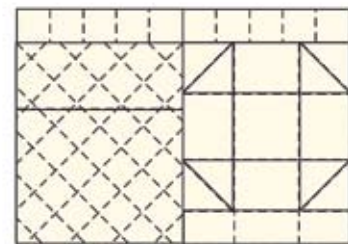
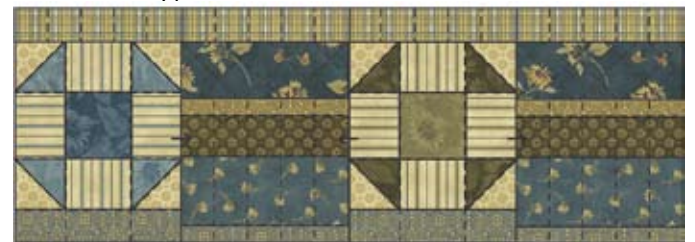

Fold joined panels in half, RST. Join ends. Press toward pocket panel

Template

7. Turn tote body inside out. Fold tote in half and stitch bottom seam as diagrammed. Stitch 2" from each side seam with a length of 2" as diagrammed to form pleats. Press pleats as shown in inset.

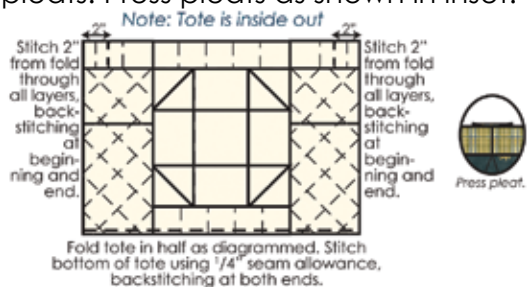

Trace template (on bottom of pg 3) onto plastic or paper and cut out. Turn tote with bottom seam facing up. Place template and mark with chalk or marking pen as shown in diagram. Stitch along drawn line through all layers. Trim excess. Note: Backstitch at beginning and end of all seams.

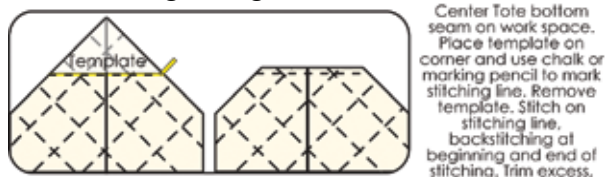

8. With Q-2, RST, stitch seam along sides and bottom as diagrammed. Stitch 2" from each side with a length of 2" to form pleats. Press pleats as shown in inset.

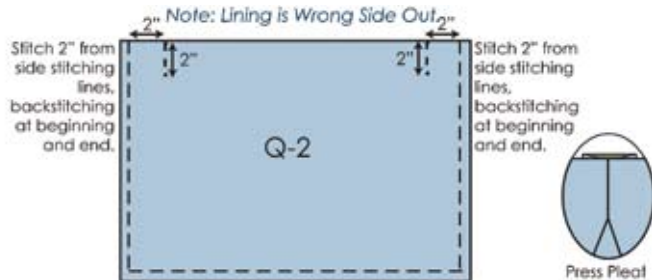

Turn tote lining with bottom seam facing up. Place template and mark with chalk or marking pen as shown in diagram. Stitch along drawn line through all layers. Trim excess. Note: Backstitch at beginning and end of seams.

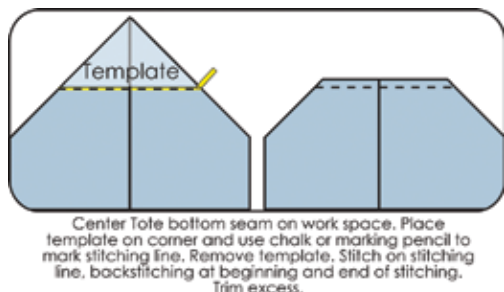

9. Mark on RSF 1/4" from raw edge, with chalk or marking pen around all sides of Q-3. Fold along drawn line toward WSF and press. See inset for mitering the corners. Fold in half, lengthwise and press. Place R-3, on WSF, along the fold crease and under the edge folds and fuse. Fold in half and stitch through all layers as diagrammed. Fold strap in half again lengthwise and stitch 1/2" from fold for a length of 1" on each end to form pleats.

Backstitch at beginning and end of pleat stitch line. Press pleat as shown in inset. (Note: You may want to baste across the pleat to keep in place when joining to the tote.)

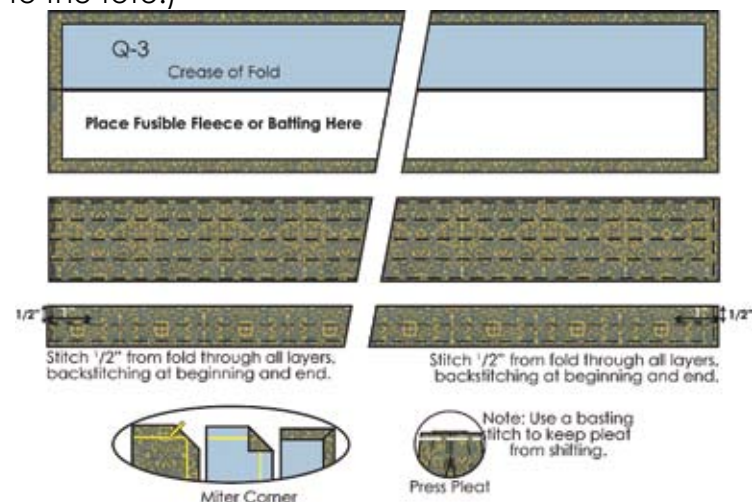

10. Turn lining right side out. Place lining into tote, lining up side pleats. Pin and baste lining to tote. Prepare binding strips. Bind top edge of tote. Attach straps to tote as diagrammed, using a very short stitch length to secure. Hand stitch strap ends to lining to finish.

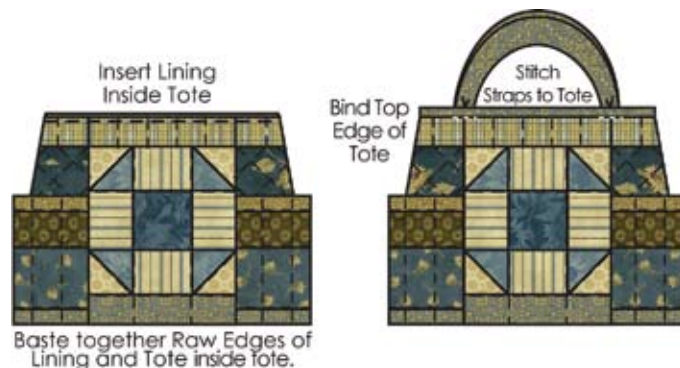

11. Fold and press long edges of Q-4. Join ends to form loop. Fold loop in half, lengthwise. Stitch close to folded edges. Twist button loop into a figure eight. Machine tack where the loops intersect.

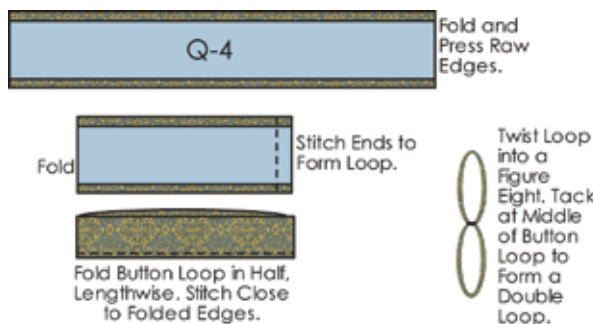

12. Stitch teardrop buttons on tote. See photo for button placement. Place button loop over each button to close tote. Stitch square buttons to bottom of tote.

Your Double Take Tote is complete.
Congratulations!

