

Pleated Purse Pattern



YOU WILL NEED:
 $\frac{1}{2}$ YARD OUTER FABRIC
 $\frac{1}{2}$ YARD LINING FABRIC
 $\frac{1}{2}$ YARD FUSIBLE INTERFACING
 MAGNETIC SNAP (OPTIONAL)

CUTTING FABRIC

	OUTER	LINING	INTERFACING
<p>3" 13" TOP</p>	2	2	2
<p>10$\frac{1}{2}$" 21" OUTSIDE (TO PLEAT)</p>	2		
<p>13" 10$\frac{1}{2}$" 21" INSIDE</p>		2	2
<p>10" 10" POCKETS</p>	2		
<p>3" 21" STRAPS</p>	2	2	2*

*CUT IN HALF LENGTHWISE

PREP FOR ASSEMBLY

CRST = RIGHT SIDES TOGETHER

① IRON INTERFACING TO WRONG SIDE OF LINING (TOP & INSIDE) PIECES

② POCKETS:

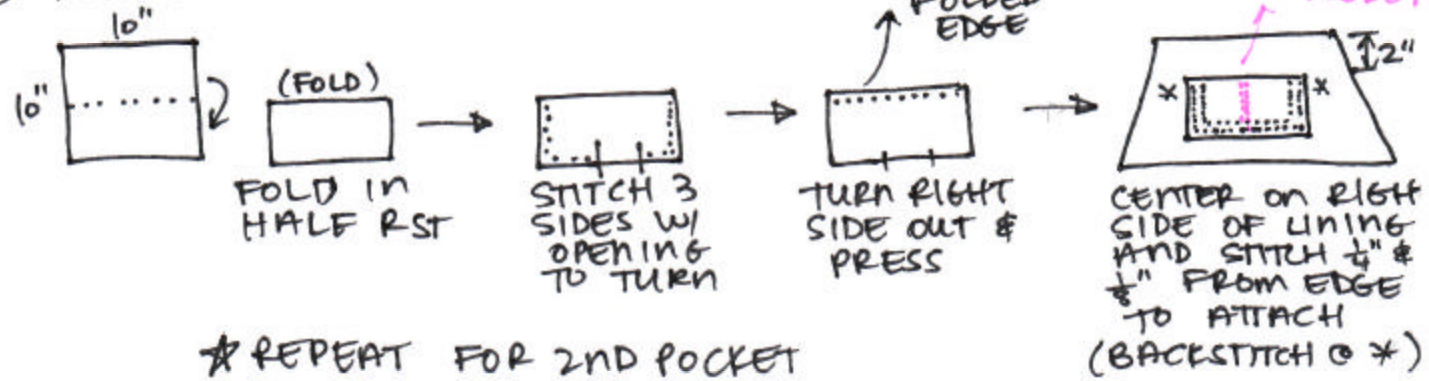

* REPEAT FOR 2ND POCKET

③ STRAPS:

- SEW 3x21" OUTER + LINING CRST ALONG ONE LONG EDGE. PRESS OPEN.
- PRESS $\frac{1}{2}$ " x 21" PIECES OF INTERFACING TO WRONG SIDE OF STRAP, JUST TO EITHER SIDE OF SEAM
- PRESS LONG SIDES OF STRAP IN, USING INTERFACING AS A GUIDE. PRESS IN HALF LENGTHWISE → SEAM SHOULD FORM ONE EDGE
- TOPSTITCH CLOSE TO EACH EDGE TO FINISH
- REPEAT FOR 2ND STRAP

④ PLEATS:

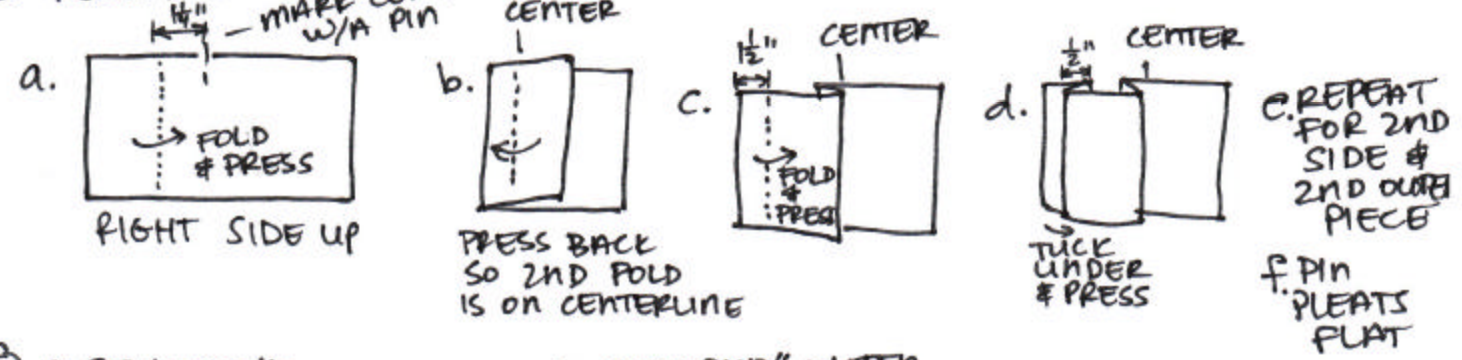

⑤ a. SEW 3x13" LINING PIECE RIGHT SIDE TO B' EDGE OF LINING

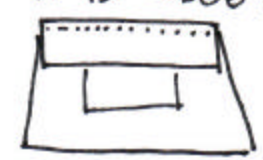

REPEAT FOR 2ND SET

b. SEW 3x13" OUTER PIECE RIGHT SIDE TO PLEATED EDGE



REPEAT FOR 2ND SET

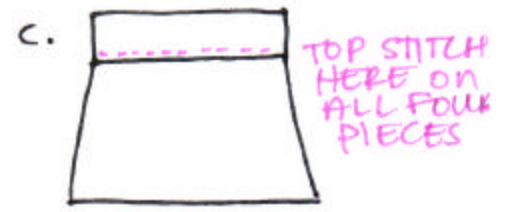

BAG ASSEMBLY

① FORM BODY

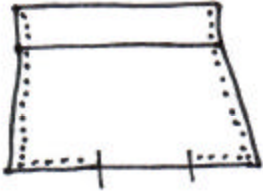

LINING PIECES RST
LEAVE GAP FOR TURNING

MITRE CORNERS

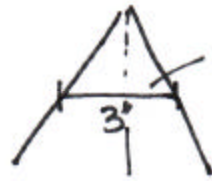

MARK W/PENCIL
DOUBLE STITCH FOR STRENGTH
MATCH SIDE & BOTTOM SEAMS TO FORM POINT

TRIM OFF POINT

- REPEAT FOR 2ND CORNER

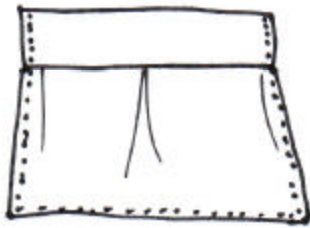

OUTER PIECES RST
STITCH ALL 3 SIDES

MITRE BOTH CORNERS AS DESCRIBED ABOVE

② ATTACH LINING TO BODY

a. PIN STRAPS INSIDE

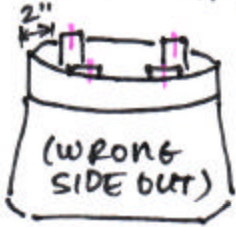

2"
LINING, LIKE FABRIC FACING TOGETHER

b. TURN OUTER BODY RIGHT SIDE OUT & TUCK IN LINING → RIGHT SIDES SHOULD BE TOGETHER

c. PIN TOP EDGE, MATCHING SIDE SEAMS, AND STITCH

d. PULL BAG RIGHT SIDE OUT THROUGH OPENING IN LINING

e. PIN TOP EDGE NEATLY AND TOP STITCH



③ ATTACH MAGNETIC SNAP TO LINING, REACHING THROUGH HOLE IN LINING TO BEND PRONGS (SEE CRAFT APPLE FOR A GOOD MAGNETIC SNAP TUTORIAL)

④ HAND STITCH OPENING IN LINING W/COORDINATING THREAD.